**Graphic technology — Process control
for the production of half-tone colour
separations, proof and production
prints —**

Part 7:

**Proofing processes working directly from
digital data**

*Technologie graphique — Contrôle des processus de confection de
sélections couleurs tramées, d'épreuves et de tirages —*

*Partie 7: Processus d'épreuve travaillant directement à partir de
données numériques*



PDF disclaimer

This PDF file may contain embedded typefaces. In accordance with Adobe's licensing policy, this file may be printed or viewed but shall not be edited unless the typefaces which are embedded are licensed to and installed on the computer performing the editing. In downloading this file, parties accept therein the responsibility of not infringing Adobe's licensing policy. The ISO Central Secretariat accepts no liability in this area.

Adobe is a trademark of Adobe Systems Incorporated.

Details of the software products used to create this PDF file can be found in the General Info relative to the file; the PDF-creation parameters were optimized for printing. Every care has been taken to ensure that the file is suitable for use by ISO member bodies. In the unlikely event that a problem relating to it is found, please inform the Central Secretariat at the address given below.

STANDARDSISO.COM : Click to view the full PDF of ISO 12647-7:2007



COPYRIGHT PROTECTED DOCUMENT

© ISO 2007

All rights reserved. Unless otherwise specified, no part of this publication may be reproduced or utilized in any form or by any means, electronic or mechanical, including photocopying and microfilm, without permission in writing from either ISO at the address below or ISO's member body in the country of the requester.

ISO copyright office
Case postale 56 • CH-1211 Geneva 20
Tel. + 41 22 749 01 11
Fax + 41 22 749 09 47
E-mail copyright@iso.org
Web www.iso.org

Published in Switzerland

Contents

Page

Foreword	iv
Introduction	v
1 Scope	1
2 Normative references	1
3 Terms and definitions	2
4 Requirements	2
4.1 Data files, simulation of screens	2
4.2 Proof print.....	3
5 Test methods	6
5.1 Control strip	6
5.2 Additional test objects	7
5.3 Colour measurement	7
5.4 Measurement of tone values by tristimulus colorimeter or spectrophotometer	8
5.5 Measurement of gloss	8
5.6 Visual appraisal of proof-press-print matches	8
Annex A (normative) Certification	9
Annex B (normative) Rub resistance of the proof colorant	11
Annex C (normative) Outer gamut patches	15
Annex D (informative) Organizational certification routines for visual appraisal of proof-print press-print matches	18
Bibliography	20

Foreword

ISO (the International Organization for Standardization) is a worldwide federation of national standards bodies (ISO member bodies). The work of preparing International Standards is normally carried out through ISO technical committees. Each member body interested in a subject for which a technical committee has been established has the right to be represented on that committee. International organizations, governmental and non-governmental, in liaison with ISO, also take part in the work. ISO collaborates closely with the International Electrotechnical Commission (IEC) on all matters of electrotechnical standardization.

International Standards are drafted in accordance with the rules given in the ISO/IEC Directives, Part 2.

The main task of technical committees is to prepare International Standards. Draft International Standards adopted by the technical committees are circulated to the member bodies for voting. Publication as an International Standard requires approval by at least 75 % of the member bodies casting a vote.

Attention is drawn to the possibility that some of the elements of this document may be the subject of patent rights. ISO shall not be held responsible for identifying any or all such patent rights.

ISO 12647-7 was prepared by Technical Committee ISO/TC 130, *Graphic technology*.

ISO 12647 consists of the following parts, under the general title *Graphic technology — Process control for the production of half-tone colour separations, proof and production prints*:

- *Part 1: Parameters and measurement methods*
- *Part 2: Offset lithographic processes*
- *Part 3: Coldset offset lithography on newsprint*
- *Part 4: Publication gravure printing*
- *Part 5: Screen printing*
- *Part 6: Flexographic printing*
- *Part 7: Proofing processes working directly from digital data*

Introduction

Part 1 of ISO 12647 serves to provide definitions, the general principles, the general order, the material to be covered in the subsequent parts 2 to 7 of ISO 12647, the definition of the data, the measurement conditions and the reporting style.

This part of ISO 12647 relates to the subject of digital proofing and establishes proofing requirements for the most stringent part of the printing and publishing market.

This part of ISO 12647 mainly lists values or sets of values, and their tolerances, of the primary parameters specified in ISO 12647-1, especially for digital proof printing. Primary parameters that define a printing condition include the screening parameters, where applicable, the colours of the solids, the colour of the print substrate, colours intermediate between these and the tone value increase curve. Adherence to these values essentially ensures that a grey, which at the colour separation stage was composed for a particular printing condition, also prints as a grey colour in proofing and printing. Remaining deviations from grey due to differences in trapping can then be removed by adjusting the coloration within the tolerances provided. This part of ISO 12647 further specifies test methods for those properties of digital proof prints and their substrates that are considered relevant for stable and reliable conditions, and thus for a certification procedure.

The graphic technology industry makes extensive use of proofing to predict the rendering of digital data files by a wide variety of high-definition, high-quality off-press printing processes and applications. Each such prediction is based on a characterization data set that defines a particular printing condition.

Typically, the specified printing condition is defined through an International Color Consortium (ICC) profile or the associated characterization data set, both of which relate source data and colorimetrically defined printed colour. Such data may be derived from printing conditions conforming to the pertinent process standard of the ISO 12647 series by industry trade groups or individuals.

The purpose of a proof print is to simulate the visual characteristics of the finished production print product as closely as possible. In order to visually match a particular printing condition, proofing processes require a set of parameters to be specified that are not necessarily identical to those put forward in ISO 12647-1 or another part of ISO 12647. This is caused by differences in colorant spectra or phenomena such as gloss, light scatter (within the print substrate or the colorant), and transparency. In such cases, it is also found that spectrophotometry takes precedence over densitometry.

Another problem area is the matching of a double-sided production print on a lightweight printing substrate, such as often used in heat-set web and publication gravure printing, to a digital proof on a nearly opaque substrate. If the proof was produced using a colour management profile based on measurements with white backing, there will be an unavoidable visual and measurable difference between the proof on the one hand and the production print placed on black on the other hand. A black backing is required for double-sided production printing on non-opaque prints, as specified in the pertinent parts of ISO 12647. The possible occurrence of such differences needs to be well communicated, in advance, to all parties concerned.

Historically there has been no consistency in the way that either the characterization data or the criteria and limits for a satisfactory match have been provided. This has led to significant redundancy and inconsistencies in the evaluation of proofing systems for different, but similar, applications, and a cost and time burden on the industry. This International Standard therefore attempts to provide guidance in this area by providing specifications and associated testing procedures.

Annex A gives the requirements for the digital proof prints listed in the main body of this part of ISO 12647; these are weighted with respect to their relevance in two typical situations:

- requirements with which a proof print, made for a particular printing condition, must comply if it is to be referenced in a contract between the printer and the provider of the digital data ("Certified Proofing System");

- requirements with which a vendor's proofing system, comprising hardware and software, must comply if it is to be considered capable of reliably producing digital contract proofs for a particular printing condition ("Certified Proofing System").

STANDARDSISO.COM : Click to view the full PDF of ISO 12647-7:2007

Graphic technology — Process control for the production of half-tone colour separations, proof and production prints —

Part 7: Proofing processes working directly from digital data

1 Scope

This part of ISO 12647 specifies requirements for systems that are used to produce hard-copy digital proof prints intended to simulate a printing condition defined by a set of characterization data. Recommendations are provided with regard to appropriate test methods associated with these requirements. In addition, guidance with respect to the certification of proofing systems related to specific printing condition aims is also included.

This part of ISO 12647 is independent of the method used to produce a digital proof print.

2 Normative references

The following referenced documents are indispensable for the application of this document. For dated references, only the edition cited applies. For undated references, the latest edition of the referenced document (including any amendments) applies.

ISO 3664, *Viewing conditions — Graphic technology and photography*

ISO 8254-1, *Paper and board — Measurement of specular gloss — Part 1: 75° gloss with a converging beam, TAPPI method*

ISO 12040, *Graphic technology — Prints and printing inks — Assessment of light fastness using filtered xenon arc light*

ISO 12639, *Graphic technology — Prepress digital data exchange — Tag image file format for image technology (TIFF/IT)*

ISO 12640-1, *Graphic technology — Prepress digital data exchange — Part 1: CMYK standard colour image data (CMYK/SCID)*

ISO 12642-2, *Graphic technology — Input data for characterization of 4-colour process printing — Part 2: Expanded data set*

ISO 12647-1:2004, *Graphic technology — Process control for the production of half-tone colour separations, proof and production prints — Part 1: Parameters and measurement methods*

ISO 13655:1996, *Graphic technology — Spectral measurement and colorimetric computation of graphic arts images*

3 Terms and definitions

For the purposes of this document, the terms and definitions given in ISO 12647-1 and the following apply.

3.1

digital proof

soft proof or hard-copy proof produced directly from digital data, on a display or a substrate

3.2

digital proof print

digital hard-copy proof

digital proof produced as a reflection copy on a proofing substrate

3.3

proofing substrate

printing substrate used for hard-copy proofing processes

3.4

half-tone proof print

proof print made using the same screening technology (generally centre-weighted half-tone dots) as the intended production printing

NOTE This is done to attempt to produce (and therefore check for the existence of) the same screening artefacts, such as rosettes, moiré or aliasing patterns, as expected in the corresponding production print. One possibility is to base proofing on the bitmap produced on the production plate or film setter.

3.5

print stabilization period

time elapsed since the production of a proof print until a stable colour is achieved

NOTE This property is to be specified by the manufacturer

4 Requirements

4.1 Data files, simulation of screens

4.1.1 Data delivery

Digital proofing systems should accept digital data delivered as PDF/X data files as defined in ISO 15930 or TIFF/IT files as defined in ISO 12639. Where TIFF/IT files are used, colour information shall be included using tag 34675 or tag 34029 as defined in ISO 12639.

NOTE PDF/X requires that the intended printing condition be indicated. Where the intended printing condition is included in the registry of characterizations maintained by the International Color Consortium (ICC) and the digital data is cyan-magenta-yellow-key (black) (CMYK), the name used in the ICC registry is usually used for identification in lieu of including an ICC output profile. If the intended printing condition is not included in said registry, PDF/X requires that an ICC output profile be included. If the data is other than CMYK, the data is required to be defined colorimetrically using an ICC input profile or another mechanism and an ICC CMYK output profile is required to be included; the rendering intent to be used with the output profile is required to be communicated.

4.1.2 Screen frequency

Half-tone proofs should have the same nominal screen frequencies (screen rulings) as the production press print to be simulated.

4.1.3 Screen angle

Half-tone proofs should have the same screen angles as the production print to be simulated.

4.1.4 Dot shape and its relationship to tone value

Half-tone proofs should have the same general dot shape as the production print to be simulated.

4.2 Proof print

4.2.1 Proofing substrate colour and gloss

The digital proofing substrate should, if possible, be the same as the substrate to be used for production printing. Where this is not possible, the digital proofing substrate should have the same gloss and CIELAB a^* and b^* values as the intended production printing substrate within the tolerances listed in Table 1. Where the characteristics of the printing substrate to be used for production printing are not exactly known, a suitable proofing substrate conforming to one of the three types given in Table 1 shall be used.

The proof and production printing substrates should ideally have similar UV responses under the recommended measurement conditions.

Annex A gives requirements for a digital proof print that are weighted with respect to their relevance.

Where the production printing substrate is not identical to the proofing substrate, the colour of the latter shall not vary by more than a CIELAB 1976 colour difference of 1,5 when successively subjected to the following keeping conditions in the dark:

- a) 24 h at 25 °C and a relative humidity of 25 %;
- b) 24 h at 40 °C and a relative humidity of 80 %;
- c) one week at 40 °C and a relative humidity of 10 %.

For the same proofing substrate, the variability of colour under light exposure is limited by the condition that the light fastness, as determined in accordance with ISO 12040, shall not be less than 3.

NOTE 1 A light fastness step of 3 corresponds approximately to a 300 d exposure to normal office lighting.

NOTE 2 In production printing, if the final print product is subjected to surface finishing, this might significantly affect the gloss and often also the colour. In critical cases, the result of the colour separation stage is best judged by means of a proof that closely matches the gloss of the final surface-finished print product. For processes with off-press finishing, in order to facilitate the matching of the production image to the proof image at the make-ready stage, it is useful to provide the press operator with two proof prints:

- a proof print whose gloss matches that of the (unfinished) production print substrate;
- a proof print which closely matches the gloss of the final surface-finished print product.

NOTE 3 If the substrate fails this test, it is in all likelihood not environmentally stable and thus not eligible for certification.

Table 1 — CIELAB coordinates, gloss and tolerances for unprinted proofing substrate types

Proofing substrate type	$L^* a$	$a^* a$	$b^* a$	Gloss ^b %
Glossy white	≥ 95	0 ± 2	0 ± 2	61 ± 15
Semi-matte white	≥ 95	0 ± 2	0 ± 2	35 ± 10
Matte white	≥ 95	0 ± 2	0 ± 2	< 25
NOTE The data specified in this table pertain to unprinted proofing substrates, not to be confused with data pertaining to unprinted production substrate which are given in other parts of ISO 12647.				
^a Measurement in accordance with 5.3.				
^b Measurement in accordance with 5.5.				

4.2.2 Coloration of printed parts

The measurement conditions shall be as specified in 5.3; the digital control strip specified in 5.1 shall be used.

The CIELAB colour coordinates of the process colour solids shall agree with the pertinent aim values of the printing condition to be simulated as given by the data (see 4.1.1), within a CIELAB difference of 5; the contribution of the CIE hue difference to the total CIELAB difference shall not exceed 2,5.

The variability of the coloration across the proof print format is limited by the provision that the colours of nine measurement locations evenly spaced on the test object (see 5.2.4), which has been printed without prior modification in view of the printing condition, shall have

- a standard deviation of less than 0,5 each for values of L^* , a^* and b^* ;
- a maximum CIELAB colour difference of 2 between the average value and any one point.

The print stabilization period shall be specified by the manufacturer. The variability ("fading") of the primary and secondary colour solids over time, in the dark, shall be limited by the condition that the CIELAB colour difference that occurs in the first 24 h after the print stabilization period has elapsed shall not exceed 1,5.

The light fastness, as determined according to ISO 12040, of the primary colour solids shall not be less than 3.

The CIELAB colour coordinates of the control patches, defined in 5.1 or ISO 12642-2, shall agree with the pertinent aim values of the printing condition to be simulated as given by the data (see 4.1.1) within the tolerances specified in Table 2.

If the proofing conditions are such that the simulation of the production printing substrate patch ($C=M=Y=K=0$, i.e. all the components are equal to zero) does require overprinting of the proofing substrate, the CIELAB deviation tolerance for that patch shall be 3, irrespective of what the pertinent part of ISO 12647 stipulates for this tolerance.

4.2.3 Repeatability of proof printing

The variability of the proof print primary and secondary colour solids and primary colour midtone patches from one day to the following shall not exceed a CIELAB colour difference ΔE of 1,5 when the patches are being measured at the same position on the sheet, and after the vendor-specified warming-up period and, if necessary, recalibration.

NOTE For certain proofing systems, the same point on a proof print may be formed from a different source on different days; strictly speaking, this is testing variability not repeatability. For these systems there is no true test of repeatability.

4.2.4 Colorant rub resistance

Using the test apparatus and method specified in Annex B, the time required by printed solids to reach mechanical stability against a rubbing action should not exceed 30 min or the print stabilization period, whichever is longer. This test shall be performed for each combination of materials and operating conditions for which the proofing system is to be certified.

NOTE A period of 30 min was chosen because this is believed to represent the expectation of the average user. Where the colour (as distinct from the rub resistance of the colorant) takes longer to stabilize, this requirement can be relaxed.

Table 2 — Additional tolerances for control patches

Control patch description	Tolerance
Simulated print substrate colour of the production printing condition ^a	$\Delta E_{ab}^* \leq 3$
All patches specified in 5.1	Maximum $\Delta E_{ab}^* \leq 6$ Average $\Delta E_{ab}^* \leq 3$
Second half-tone scale composed of the primaries C, M, Y, roughly replicating the colours of the first scale for an average printing condition ("grey balance") (same number of patches as for colours of the first scale)	Average $\Delta H \leq 1,5$
Outer gamut patches	Average $\Delta E_{ab}^* \leq 4$
All patches of ISO 12642-2	Average $\Delta E_{ab}^* \leq 4$ 95 % percentile $\Delta E_{ab}^* \leq 6$
NOTE 1 The tolerances pertain to the deviation of the proof values from the values of the characterization data of the printing condition to be simulated.	
NOTE 2 The specification of ΔE_{ab}^* tolerances lower than 3 is presently not practical due to poor inter-instrument agreement.	
NOTE 3 If the final proof print is subjected to surface finishing, the final colours might deviate significantly from those of the unfinished print. See also Note 2 in 4.2.1. In this case, a new proofer or simulation profile or other adjustments are required.	
^a Required only where the proofing substrate is not identical with the production printing substrate.	

4.2.5 Ink set gloss

The gloss of solid tone colours should be visually similar to that of the production print to be simulated. The ink set gloss may be specified if deemed necessary; see 5.5 for the method.

NOTE If the gloss of the proof print is substantially changed by the applied colorants, a surface-finishing step might improve the situation. See 4.2.2.

4.2.6 Tone value reproduction limits

Tints intermediate between the (simulated) substrate white and solid shall transfer onto the proof in a consistent and uniform manner over a tone value range that includes at least the tone reproduction limits of the printing condition to be simulated; see the pertinent part of ISO 12647 for this information.

NOTE It is good prepress practice that no image parts need to rely on tone values outside of the tone value reproduction limits of the production printing process.

4.2.7 Tone value

In addition to the requirements of 4.2.2, the single-colour CMYK patches shall not deviate in tone value (measured colorimetrically) from those of the aim characterization data by more than 5 % in tone value. For the calculation of tone values from measured and characterization CIE data, use the method described in 5.4.

4.2.8 Reproduction of vignettes

The test objects specified in 5.2.2 shall show no easily visible steps within the tone value reproduction limits (see 4.2.6), if viewed under ISO viewing condition P1 in accordance with ISO 3664.

4.2.9 Image register and resolving power

The maximum deviation between the image centres of any two printed colours shall not be larger than 0,05 mm. The resolving power of the proof print shall be such that C, M, K positive, non-serif, type of 2-point size, reverse (negative) of 8-point size and 2-point reverse line are legibly reproduced; the test object specified in 5.2.3 shall be used. The above requirements shall not apply to rough or mechanically unstable substrates such as newsprint and to cases where the tolerances for production printing are substantially greater than 0,05 mm.

NOTE 1 This condition usually corresponds to an output addressability of at least 100 pixels per centimetre.

NOTE 2 This condition includes the effects of colorant migration, if at all present.

4.2.10 Margin information

Every digital proof shall bear a human-readable commentary line printed on a margin where the proofing system designation, the colorant and substrate material types, the printing condition to be simulated, the colour management profile(s) used and the time and date are given.

NOTE 1 For ink-jet printers, it is useful to print a nozzle test line next to the commentary line so that it is possible to ascertain in retrospect that all nozzles were working.

NOTE 2 In some cases of recalibration, it is useful to reprofile the proofer.

4.2.11 Gamut

For each printing condition to be simulated, the 226 outer gamut patches of ISO 12642-2 shall be proof printed. The average CIELAB 1976 colour difference between actual and aim values for those patches shall not exceed 4; see also Table 2. See Annex C for the list of outer gamut patches of ISO 12642-2.

5 Test methods

5.1 Control strip

On every proof, print a CMYK digital control strip at the output intent of the printing condition to be simulated. The control elements identified in the list below should be included while keeping the total number of patches within reasonable limits. To provide compatibility with characterization data, as many control patches as possible should be selected from ink value combinations of ISO 12642-2. Select the control patches such that the following control patch types are covered:

- a) solid tones of the chromatic primaries and their secondaries C,M,Y,R,G and B (6 patches);
- b) mid- and shadow tones of the chromatic primaries and their secondaries C,M,Y,R,G and B (12 patches);
- c) black (K) only half-tone scale with a minimum of six steps that includes the solid;
- d) CMY overprint half-tone scale having the same number of steps as the scale in c) that approximately replicates, for an average printing condition, the CIELAB values of the black only scale defined in c);
- e) selection of critical tertiary colours such as flesh tones, brown, aubergine, violet (e.g. 15 patches);
- f) simulated print substrate colour of the production printing condition (1 patch).

NOTE 1 There are two practical definitions for grey which are sometimes contradictory:

- "A colour having the same a^* and b^* CIELAB values as the print substrate";
- "A colour having the same a^* and b^* CIELAB values as a half-tone tint of similar L^* value printed with black ink".

The latter definition is believed to be useful in the midtone and upwards whereas the former is believed to work best with highlight tones.

NOTE 2 Grey balance patches composed of suitable CMY mixtures serve a useful purpose for quick visual checks of whether the CMY tone values have changed, for example from one proof print to the next. A single grey balance condition is usually not sufficient to ensure an achromatic colour for all print substrates and printing inks that are used for a given printing condition. In addition, it usually depends on the particular black composition used.

5.2 Additional test objects

5.2.1 For the visual determination of resolving power of the proofing process, take the resolution charts S2 and S3 defined in ISO 12640-1.

5.2.2 For checks of the primary and secondary process colours C, M, Y, K, R, G, B, and C+M+Y, take vignette targets such as the test image S6 of ISO 12640-1. Dimension the length of the vignettes such that they are just below the length where less than smooth behaviour would set in with normal production printing.

5.2.3 For checks on the resolving power with type material, take positive and reverse (negative) type of a non-serif font with point sizes of 2, 3, 4, 5, 6, 7 and 8. Also use reverse lines with the point sizes of 2, 3 and 4.

5.2.4 For checks on uniformity, create three formes, each with an even tint area that fills the printable format of the proof printer, using the following tone value combinations.

- a) C: 65 %, M: 50 %, Y: 50 %, K: 50 %;
- b) C: 40 %, M: 30 %, Y: 30 %, K: 30 %;
- c) C: 20 %, M: 15 %, Y: 15 %, K: 15 %.

NOTE The most popular format for proof printing is A3+.

5.3 Colour measurement

Colour measurements shall be made using an instrument (such as a colorimeter, or a spectrophotometer from which colorimetric values can be calculated) that is capable of repeatedly producing measured values well within the tolerances specified in this part of ISO 12647. The CIELAB colour co-ordinates L^* , a^* , b^* shall be calculated as detailed in ISO 13655:1996, B.1. The ISO 13655 measurement condition and backing should be selected based on correspondence with the press and proof viewing condition. The CIELAB 1976 colour difference shall be calculated as detailed in ISO 13655:1996, B.3.

Black backing shall be in accordance with ISO 13655:1996, Annex D. Standard white backing shall have the following characteristics.

- a) It shall be opaque (e.g. ceramic, plastic or paper).
- b) It shall be diffuse-reflecting (i.e. no perceptible specular reflection when viewed at any angle under typical office room illumination conditions).
- c) Its CIELAB C^* value shall not exceed 3,0.
- d) It shall be non-fluorescing (no emission in the response band of interest when excited by the instrument source).
- e) The spectral reflectance factor values shall exceed those of Table 3 but the CIE L^* value shall not exceed 96,4.

Table 3 — Spectral reflectances

Wavelength nm	Spectral reflectance
400	0,30
410	0,30
420	0,75
450	0,75
460	0,80
670	0,80
680	0,75
700	0,75
NOTE These spectral reflectance values correspond to a CIE L^* value greater than 92.	

NOTE If the viewing condition is ISO 3664 condition P1 with white backing, as recommended in Annex D, the most appropriate measurement condition will be ISO 13655 measurement condition with white backing.

5.4 Measurement of tone values by tristimulus colorimeter or spectrophotometer

Measure single-process-colour half-tone patches as directed in 5.3. Calculate tone values in accordance with the method given in ISO 12647-1:2004, 5.3.2.

5.5 Measurement of gloss

Measure the specular gloss of the print substrate or ink set single print solid areas with light incident at 75° (15° from the plane of the print substrate) and measurement at 75°. Use an instrument that conforms to ISO 8254-1. Report values in percent, quoting "ISO 8254-1 TAPPI gloss" as the method.

5.6 Visual appraisal of proof-press-print matches

See Annex D for a typical set of guidelines used for visual evaluations.

NOTE 1 Although industry is struggling to develop metrologically based techniques for the evaluation of the quality of proof-to-print matches, unfortunately most industry trade groups still rely on visual comparisons. It is recognized that these evaluations are highly dependent on both the subject matter chosen and on the observers participating.

Annex A (normative)

Certification

A.1 Digital hard-copy proof production in the field

A.1.1 General provisions

Production sites for digital proofs may be considered capable of delivering certified ("contract") proofs for a chosen printing condition in conformance with this part of ISO 12647 if it can be reliably demonstrated, by a suitably equipped third party, that the proof prints conform to the requirements listed in A.1.2 or A.1.3 for the chosen printing condition.

A.1.2 Half-tone type proof prints

Half-tone type proof prints shall conform to the following requirements of Clause 4:

- 4.1.2, screen frequency;
- 4.1.3, screen angle;
- 4.1.4, half-tone dot shape;
- 4.2.1, proofing substrate colour and gloss; conformance to Table 1 is the only requirement;
- 4.2.2, coloration of printed parts, except the light fastness and 24 h colour fading tests;
- 4.2.7, tone value;
- 4.2.8, reproduction of vignettes;
- 4.2.9, image register and resolving power;
- 4.2.10, margin information;
- 4.2.11, gamut.

A.1.3 Non-half-tone type proof prints

Non-half-tone type proof prints shall conform to all requirements of A.1.2 except those for screen frequency (4.1.2), screen angle (4.1.3) and half-tone dot shape (4.1.4).

A.2 Production system for digital hard-copy proofing

A.2.1 General provisions

Production systems for digital proofing provided by vendors may be considered capable of delivering certified ("contract") proofs for a given printing condition in conformance with this part of ISO 12647 if it can be reliably demonstrated, by a suitably equipped third party, that the proofing system, comprising hardware and workflow components, if tested under the environmental conditions specified by the vendor, conforms to the

requirements listed in A.2.2 or A.2.3 for said printing condition. In addition, the system shall be capable of accepting and processing data files conforming to 4.1.1.

A.2.2 Half-tone type proof prints

Half-tone type proof prints shall conform to the following requirements of Clause 4:

- 4.1.2, screen frequency;
- 4.1.3, screen angle;
- 4.1.4, half-tone dot shape;
- 4.2.1, proofing substrate colour and gloss; conformance to Table 1 is the only requirement;
- 4.2.2, coloration of printed parts, except the light fastness and 24 h colour fading tests;
- 4.2.3, repeatability of proof printing;
- 4.2.4, colorant rub resistance;
- 4.2.6, tone value reproduction limits;
- 4.2.7, tone value;
- 4.2.8, reproduction of vignettes;
- 4.2.9, image register and resolving power;
- 4.2.10, margin information;
- 4.2.11, gamut.

A.2.3 Non-half-tone type proof prints

Non-half-tone type proof prints shall conform to all requirements of A.1.2 except those for screen frequency (4.1.2), screen angle (4.1.3) and half-tone dot shape (4.1.4).

Annex B (normative)

Rub resistance of the proof colorant

B.1 Apparatus

B.1.1 Slab

For the procedure, a stainless steel slab is used, having dimensions according to Figure B.1, with a mass of approximately 400 g, a protruding wipe area of 10 cm² and hence a ratio of mass per area of 0,4 N/cm². A pull string is attachable to the front of the slab by means of two screws whose heads have a hole (see item 1 of Figure B.1).

NOTE 1 This procedure is modelled after method A of DIN 53131-2 [6].

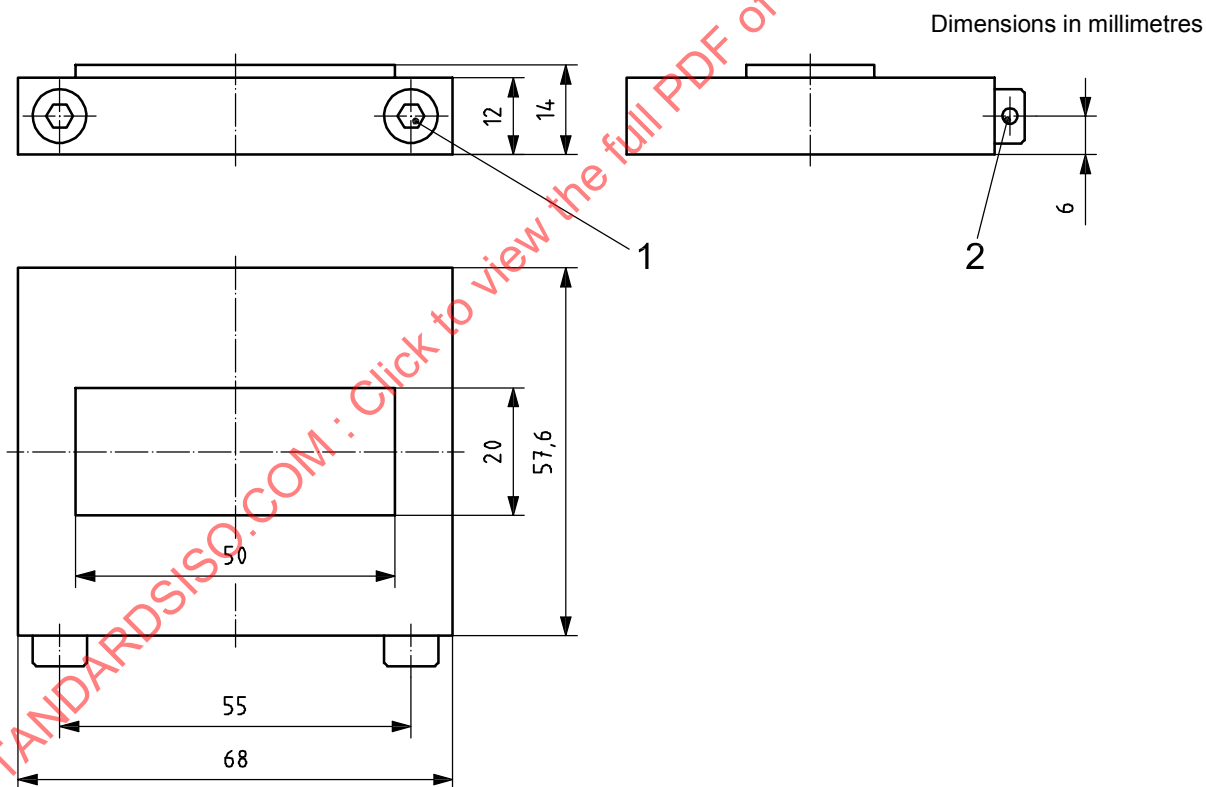

Key

- 1 screw M5
- 2 hole, of 2 mm to 3 mm in diameter, for fastening of pull string

Figure B.1 — Slab

B.1.2 Rubber mat

Rubber mat with the following properties:

- thickness: 2 mm;
- length: 340 mm;
- width: 250 mm;
- Shore-A hardness: 65 A;
- smooth matte surface.

B.2 Proofing system

The results of this test only pertain to the particular combination of proofing system, hardware, firmware, driver setting and software, and the particular proofing substrate and colorant material used.

B.3 Printed test area

Prepare a test forme with six printed rectangular test areas having an approximate size of 25 mm by 36 mm. Fill three rectangles with black ink type and the rest each with 6 strips of C100, M100, Y100, C100+M100, C100+Y100, M100+Y100, each strip parallel to the shorter side of the rectangles. See Figure B.2 for an example layout.



Key

- 1 text sample area
- 2 colour sample area

Figure B.2 — Example layout for printed test objects

B.4 Rub test

B.4.1 Climatic conditions

Strictly observe the temperature and relative humidity ranges specified by the vendor. Place all materials and test devices in that environment at least 24 h prior to the test.

B.4.2 Preparation of the slab

Fasten a piece of unprinted proofing substrate of the type to be tested, 40 mm by 80 mm, to the front part of the slab such that it extends rearwards over the protruding part of the slab. Orient the normal printing side of the proofing paper away from the slab so that this surface will come in contact with the printed test area.

B.4.3 Test

Attach a 40 cm pull string to the screws of the slab (item 1 in Figure B.1) so that the slab may be pulled to slide over the table surface. Place the rubber mat on a flat table. Firmly attach the proof print (with its six rectangular test objects, see Figure B.2) to the rubber mat, printed side up.

Place the prepared slab on the proof print behind a rectangular printed object, with the protruding part facing the proof print. Orient the slab such that longer sides of the protruding part of the slab and those of the printed test area are parallel. At a speed of approximately 5 cm/s, pull the slab fully across the chosen test area in the direction perpendicular to its longer side. Do not apply vertical forces to the slab. While pulling the slab, keep the string parallel to the table surface. Inspect the substrate attached to the bottom of the slab. If it is marked by transferred colorant, replace it with a fresh piece of proofing substrate. Repeat the rubbing pulls for the remaining five test areas.

B.4.4 Evaluation

Visually scrutinize the printed test areas and the adjacent unprinted parts for traces of the rubbing action. Visually examine the proofing substrate that was attached to the slab for traces of transferred colorant. For the striped test areas, note which colorant is affected most by the rubbing.

B.4.5 Mechanical stabilization period of colorant

Determine the colorant mechanical stabilization period as follows. Make a series of tests according to B.4.3, starting immediately after the proof print fully emerges from the proofing system. Repeat at least three times, at evenly spaced intervals of approximately 10 min. The time elapsed after printing till the point when no visual traces of the rubbing action can be seen is the colorant mechanical stabilization period.

B.5 Test report

The test report shall include the following details:

- a) a reference to this part of ISO 12647 (ISO 12647-7:2007);
- b) the proofing substrate (vendor, type, article number);
- c) the colorant (vendor, type, article number);
- d) the proof printer (vendor, type, article number);
- e) the printer driver and setting (vendor, type, version);
- f) the application program (vendor, type, version);

- g) the raster image processor (RIP) (type and version);
- h) the operating system (vendor, type, version);
- i) the test conditions and any deviations from this part of ISO 12647 that might have influenced the results;
- j) the test results;
- k) the date and name of person carrying out the test.

STANDARDSISO.COM : Click to view the full PDF of ISO 12647-7:2007

Annex C (normative)

Outer gamut patches

Table C.1 contains a selected subset of outer gamut patches of ISO 12642-2. The outer gamut patch set is also a subset of the patches defined in ISO 12642-2. The first column of Table C.1 gives the order number used in ISO 12642-2. The remaining columns give the data tone values of the patches.

Table C.1 — 226 outer gamut patches of ISO 12642-2

No.	C	M	Y	K
1	0	0	0	0
2	0	10	0	0
3	0	20	0	0
4	0	30	0	0
5	0	40	0	0
7	0	70	0	0
9	0	100	0	0
10	10	0	0	0
11	10	10	0	0
12	10	20	0	0
14	10	40	0	0
16	10	70	0	0
18	10	100	0	0
19	20	0	0	0
20	20	10	0	0
21	20	20	0	0
23	20	40	0	0
25	20	70	0	0
27	20	100	0	0
28	30	0	0	0
37	40	0	0	0
38	40	10	0	0
39	40	20	0	0
41	40	40	0	0
43	40	70	0	0
45	40	100	0	0
55	70	0	0	0
56	70	10	0	0
57	70	20	0	0

No.	C	M	Y	K
59	70	40	0	0
61	70	70	0	0
63	70	100	0	0
73	100	0	0	0
74	100	10	0	0
75	100	20	0	0
77	100	40	0	0
79	100	70	0	0
81	100	100	0	0
82	0	0	10	0
83	0	10	10	0
84	0	20	10	0
86	0	40	10	0
88	0	70	10	0
90	0	100	10	0
91	10	0	10	0
100	20	0	10	0
118	40	0	10	0
136	70	0	10	0
154	100	0	10	0
163	0	0	20	0
164	0	10	20	0
165	0	20	20	0
167	0	40	20	0
169	0	70	20	0
171	0	100	20	0
172	10	0	20	0
181	20	0	20	0
199	40	0	20	0

No.	C	M	Y	K
217	70	0	20	0
235	100	0	20	0
244	0	0	30	0
325	0	0	40	0
326	0	10	40	0
327	0	20	40	0
329	0	40	40	0
331	0	70	40	0
333	0	100	40	0
334	10	0	40	0
343	20	0	40	0
361	40	0	40	0
379	70	0	40	0
397	100	0	40	0
487	0	0	70	0
488	0	10	70	0
489	0	20	70	0
491	0	40	70	0
493	0	70	70	0
495	0	100	70	0
496	10	0	70	0
505	20	0	70	0
523	40	0	70	0
541	70	0	70	0
559	100	0	70	0
649	0	0	100	0
650	0	10	100	0
651	0	20	100	0
653	0	40	100	0

No.	C	M	Y	K
655	0	70	100	0
657	0	100	100	0
658	10	0	100	0
667	20	0	100	0
685	40	0	100	0
703	70	0	100	0
721	100	0	100	0
735	0	100	0	20
741	10	100	0	20
747	20	100	0	20
753	40	100	0	20
759	70	100	0	20
760	100	0	0	20
761	100	10	0	20
762	100	20	0	20
763	100	40	0	20
764	100	70	0	20
765	100	100	0	20
771	0	100	10	20
796	100	0	10	20
807	0	100	20	20
832	100	0	20	20
843	0	100	40	20
868	100	0	40	20
879	0	100	70	20
904	100	0	70	20
910	0	0	100	20
911	0	10	100	20
912	0	20	100	20
913	0	40	100	20
914	0	70	100	20
915	0	100	100	20
916	10	0	100	20
922	20	0	100	20
928	40	0	100	20
934	70	0	100	20
940	100	0	100	20
950	0	100	0	40
955	20	100	0	40

No.	C	M	Y	K
960	40	100	0	40
965	70	100	0	40
966	100	0	0	40
967	100	20	0	40
968	100	40	0	40
969	100	70	0	40
970	100	100	0	40
975	0	100	20	40
991	100	0	20	40
1000	0	100	40	40
1016	100	0	40	40
1025	0	100	70	40
1041	100	0	70	40
1046	0	0	100	40
1047	0	20	100	40
1048	0	40	100	40
1049	0	70	100	40
1050	0	100	100	40
1051	20	0	100	40
1056	40	0	100	40
1061	70	0	100	40
1066	100	0	100	40
1075	0	100	0	60
1080	20	100	0	60
1085	40	100	0	60
1090	70	100	0	60
1091	100	0	0	60
1092	100	20	0	60
1093	100	40	0	60
1094	100	70	0	60
1095	100	100	0	60
1100	0	100	20	60
1116	100	0	20	60
1125	0	100	40	60
1141	100	0	40	60
1150	0	100	70	60
1166	100	0	70	60
1171	0	0	100	60
1172	0	20	100	60

No.	C	M	Y	K
1173	0	40	100	60
1174	0	70	100	60
1175	0	100	100	60
1176	20	0	100	60
1181	40	0	100	60
1186	70	0	100	60
1191	100	0	100	60
1199	0	100	0	80
1203	40	100	0	80
1207	70	100	0	80
1208	100	0	0	80
1209	100	40	0	80
1210	100	70	0	80
1211	100	100	0	80
1215	0	100	40	80
1224	100	0	40	80
1231	0	100	70	80
1240	100	0	70	80
1244	0	0	100	80
1245	0	40	100	80
1246	0	70	100	80
1247	0	100	100	80
1248	40	0	100	80
1252	70	0	100	80
1256	100	0	100	80
1262	0	100	0	100
1266	100	0	0	100
1268	100	100	0	100
1278	0	0	100	100
1280	0	100	100	100
1284	100	0	100	100
1290	90	0	0	0
1292	80	0	0	0
1295	60	0	0	0
1296	50	0	0	0
1299	25	0	0	0
1301	15	0	0	0
1303	7	0	0	0
1305	3	0	0	0